

RB520GM9-30 Schottky Barrier Diode

Features

- ◆ Low current rectification
- ◆ Low reverse current
- ◆ SOD923 Micro SMD package
- ◆ RoHS compliant
- ◆ UL-94 V-0 / Green EMC
- ◆ Matte Tin Lead finish (Pb-Free)
- ◆ Cathode Band / Device marking
- ◆ Device Marking Code: C1/E

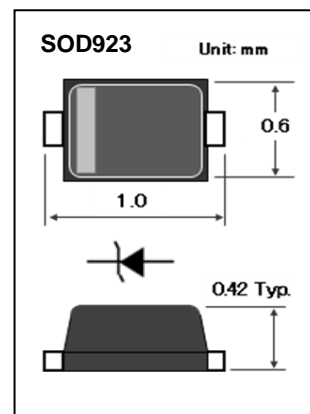

Absolute Maximum Ratings ($T_A=25^\circ\text{C}$ unless otherwise specified)

Symbol	Parameter	Value	Units
VR	Reverse Voltage	30	V
VRRM	Repetitive Peak Reverse Voltage	30	V
IO	Continuous Forward Current	100	mA
IFSM	Non-Repetitive Peak Forward Current *1	0.6	A
TJ	Junction Temperature	125	$^\circ\text{C}$
TSTG	Storage Temperature	-55 to +125	$^\circ\text{C}$

*1 8.3 ms single half sine-wave

Electrical Characteristics ($T_A=25^\circ\text{C}$ unless otherwise specified)

Symbol	Parameter	Conditions	Min	TYP	Max	Units
V_F	Forward Voltage	$I_F = 1\text{mA}$		0.32	0.37	V
		$I_F = 10\text{mA}$		0.40	0.45	V
		$I_F = 30\text{mA}$		0.47	0.55	V
BV_R	Breakdown Voltage	$I_R = 10\ \mu\text{A}$	30			V
I_R	Reverse Current	$V_R = 10\text{V}$			0.5	μA

SOD-923 Package Outline Drawing

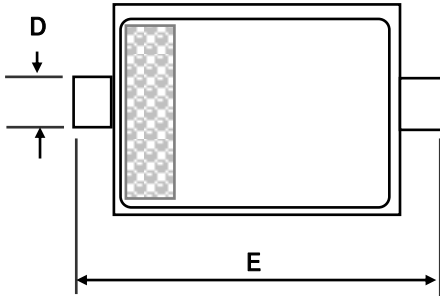
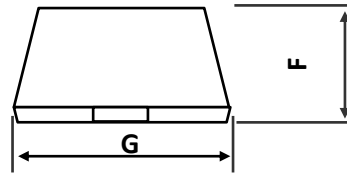
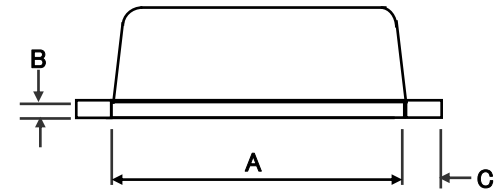

Dimensions

Unit	A	B	C	D	E	F	G
Max.	0.90	0.20	0.15	0.30	1.10	0.45	0.65
Min.	0.70	0.05	0.05	0.15	0.90	0.39	0.55

Unit: mm

SOD923 * Package Outline

Suggested Land Pattern

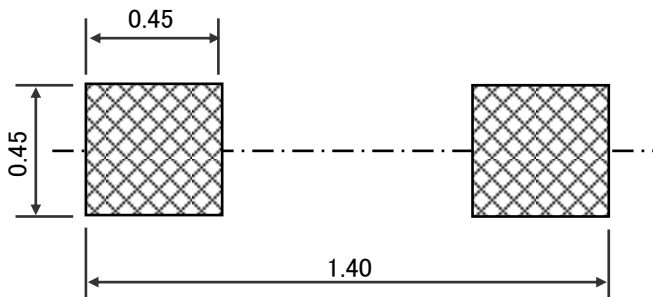

Contact Information

Changzhou D-first Electronics CO.,Ltd.

www.first-electronic.com

Email: xhf@first-electronic.cn

Phone: +86 (0519) 8817 1671